

## Product List



### LMP-1204G-SFP-bt Series

#### 12-port Industrial Managed IEEE 802.3bt PoE Gigabit Ethernet Switch

- 4\*10/100/1000Tx IEEE 802.3bt 90W PoE
- 4\*10/100/1000Tx IEEE 802.3af/at PoE+
- 4\*100/1000Base-Tx SFP Slot
- 12-55VDC Dual Power Input for Redundancy



### LMP-0702G-SFP-bt Series

#### 7-port Industrial Managed IEEE 802.3bt PoE Gigabit Ethernet Switch

- 4\*10/100/1000Tx IEEE 802.3bt 90W PoE
- 1\*10/100/1000Tx Gigabit Ethernet
- 2\*100/1000Base-Tx SFP Slot
- 12-55VDC Dual Power Input for Redundancy



### LMP-C602G-SFP-bt Series

#### 6-port Industrial Compact Managed IEEE802.3bt PoE Gigabit Ethernet Switch

- 4\*10/100/1000Tx IEEE 802.3bt 90W PoE
- 2\*100/1000Base-Tx SFP Slot
- Compact Size Design
- 48-55VDC Dual Power Input for Redundancy



### LNP-0500G-bt Series

#### 5-port Industrial Compact IEEE802.3bt PoE Gigabit Ethernet Switch

- 4\*10/100/1000Tx IEEE 802.3bt 90W PoE
- 1\*10/100/1000Tx Gigabit Ethernet
- 12-55VDC Dual Power Input for Redundancy



### LNP-C501G-SFP-bt Series

#### 5-port Industrial Compact IEEE 802.3bt PoE Gigabit Ethernet Switch

- 4\*10/100/1000Tx IEEE 802.3bt 90W PoE
- 1\*100/1000Base-Tx SFP Slot
- Compact Size Design
- 12-55VDC Dual Power Input for Redundancy



### IMP-C1000-SFP-bt Series

#### Industrial IEEE 802.3bt PoE Gigabit Media Converter

- 1\* 10/100/1000Tx IEEE 802.3bt 90W PoE
- 1\* 100/1000 Base-Tx SFP Slot
- PD Remote Reset Technology(PRRT)
- Link Fault Pass Through(LFP)
- Compact Size Design
- 12-55VDC Dual Power Input for Redundancy

**antaira**<sup>®</sup>  
making connectivity simple...

## Build a Reliable & Robust Industrial Network with Antaira

Antaira Technologies is a leading developer and manufacturer that provides high-quality industrial networking and communication product solutions for more than 10 years. Focusing on networking in harsh environments, Antaira's products feature high reliability, extended temperature tolerance, and rugged enclosure designs. To know more about Antaira, visit Antaira website: [www.antaira.com.tw](http://www.antaira.com.tw)

### Headquarters US/Canada/South America

Tel: +1-714-671-9000  
Fax: +1-714-671-9944  
[info@antaira.com](mailto:info@antaira.com)

### Asia Branch Asia/Middle East/Africa

Tel: +886-2-2218-9733  
Fax: +886-2-2218-7391  
[info@antaira.com.tw](mailto:info@antaira.com.tw)

### Europe Branch Europe/Russia

Tel: +48-22-862-88-81  
Fax: +48-22-862-88-82  
[info@antaira.eu](mailto:info@antaira.eu)



©2020 Antaira Technologies, Co., Ltd. All Rights Reserved.

BT PoE SERIES

## Easily Connect & Power Up for Your High-Power PoE Networks

Facilitate industrial 90W PoE network now



**antaira**<sup>®</sup>  
making connectivity simple...

# Product Overview

PoE (Power over Ethernet) technology is widely adopted for supporting networking devices power and connectivity when facing the challenge of wiring in rigorous environments with power sourcing limitations. IEEE standards specify the maximum power output from PSE (power sourcing equipment) as well as the power budget for the PD (powered device) to ensure the interoperability of both devices in the market.

With the increasing need of higher power in applications, the maximum PD power available is increased by this amendment to IEEE standards.

## IEEE 802.3af

Power Sourced  
15.4W

Power Requested  
13W



IP Camera



IP Phone

## IEEE 802.3at

Power Sourced  
30W

Power Requested  
25.5W



Wireless AP



IP Camera

## IEEE 802.3bt

Power Sourced  
90W

Power Requested  
71.3W



PTZ Camera



PTZ Controller



Smart Lighting



Digital Signage



POS System

Making Connectivity Simple...

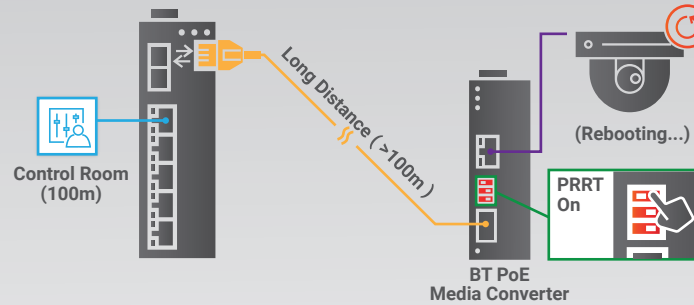

## Time-Saving. Effort-Saving.

### PRRT (PD Remote Reset Technology)

Enabling PRRT function can save you hours, miles and lots of efforts. With simply pull and plug on fiber cable of networking device connected with BT PoE product in the near field site, remote PSE system can be rebooted to reset remote PD devices.

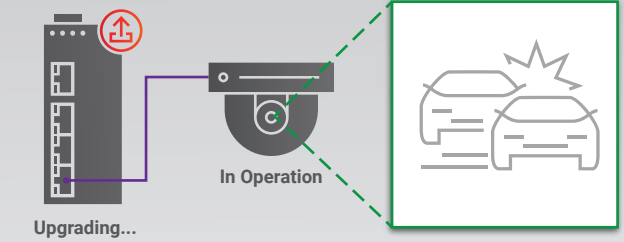

## Persistent PoE

PD devices are connected to collect important data for a wide array of crucial applications, such as video surveillance, to guarantee personal and property safety. It is one of the most users' concerns when it comes to PD devices shut-down in a key moment.

Antaira's Persistent PoE provides uninterrupted power delivery to PD devices even when the products are being upgraded, ensuring PD devices smooth operation with no worry.

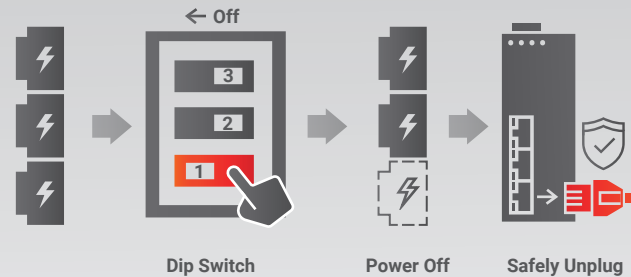

## Easy PoE Power Management

### Safe PoE Disable

With simple flick, users can easily disable PoE powering to safely unplug the copper cable.

## Responsive PoE Management

Users are able to manage the PoE devices according to different operating status with both hardware and software reminders thoroughly.

- PoE Budget
- Ping Alive
- PoE Schedule
- Event Indicator
- PoE Loading

